

NO.	DESCRIPTION	NO.	DESCRIPTION
1	ENGINE	28	BRACKET
2	CLUTCH	29	LEFT HANDLE SLEEVE
3	OIL SEALING Ø20*47*7	30	CORD SLEEVE
4	PLANE BEARING Ø10*24*4	31	WASHER Ø6*22*1.5
5	INNER CIRCLIP Ø47 (65MN)	32	Ø6 SPRING WASHER
6	BEARING 6204RS	33	M6*25 BOLT
7	WORM SCREW	34	PIN
8	SMALL BUSH	37	PIN 8*37
9	REDUCER	38	CONNECTION PIECE
10	FLAT WASHER Ø8*20*1.5	39	M12*16 BOLT
11	FLAT WASHER Ø20*30*3	40	HANDLE ASSEMBLY
12	SPRING Ø35 (65MN)	41	TORQUE SPRING
13	WORM GEAR CASE	42	THROTTLE WIRE
14	M6*25 INNER HEXAGON BOLT ASSEMBLY	36	SWITCH WIRE
15	M6 SPRING WASHER	43	M5 SCREW
16	MIDDLE BUSH	44	THROTTLE TRIGGER
17	FLAT WASHER Ø17*30*2	45	NUT
18	WORM GEAR	46	BODY COVER
19	WORM GEAR SHAFT	47	CORD CLIP
20	WASHER Ø20*30*3	48	COPPER SHEET
21	BIG BUSH	49	SWITC OFF SHEET
22	O RING Ø100*3	50	TAPPING SCREW ST3X12
23	WORM CASE COVER	51	TOP COVER
24	M6*16 HEXAGON BOLT	52	ENGINE ON/OFF SWITCH
25	OIL SEALING Ø20*35*7	100	THROTTLE SWITCH ASSEMBLY
26	ANTI-SHOCK SHEET		
27	RUBBER MAT		

SO20120820

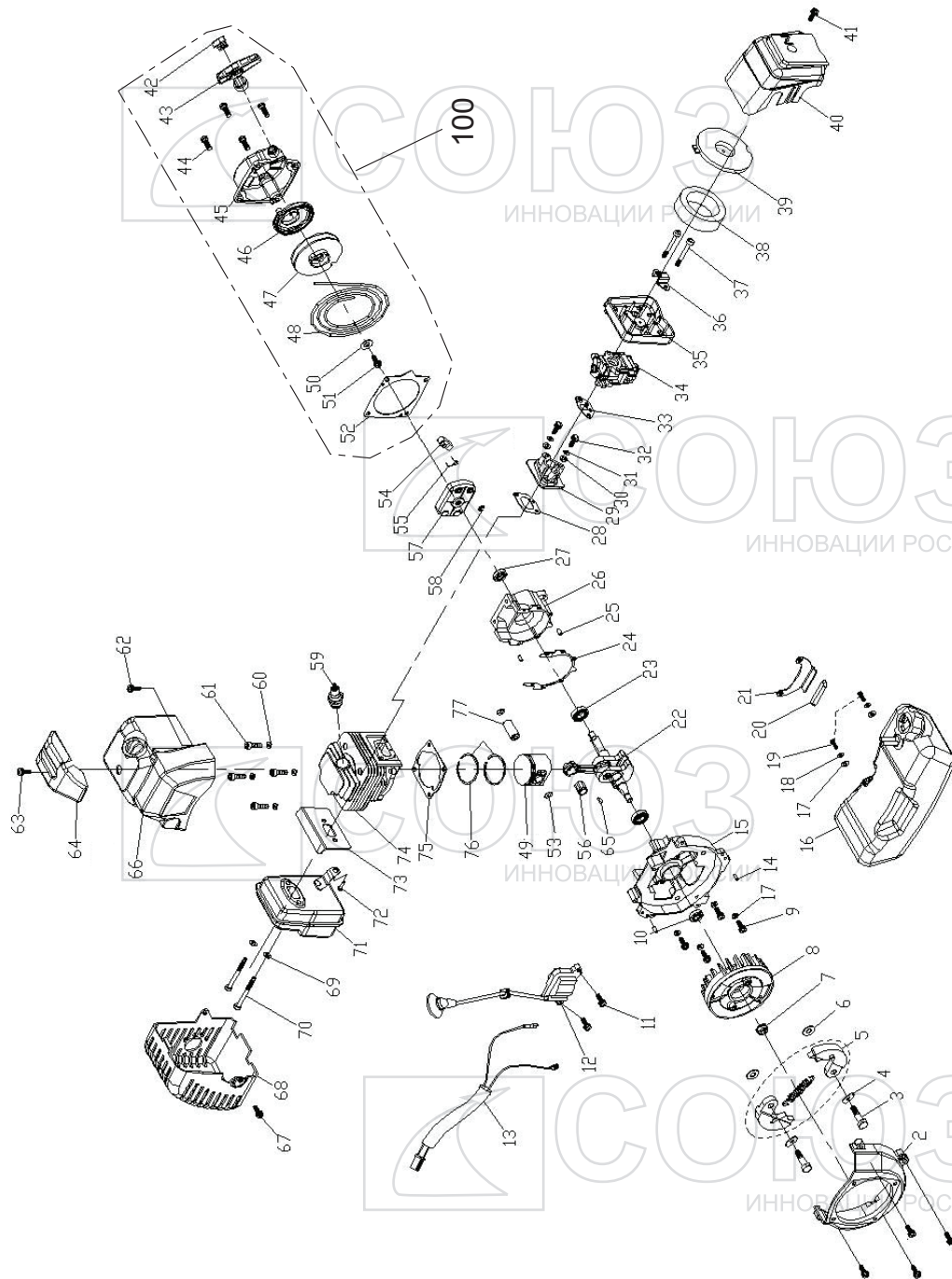



## ENGINE FOR БС-2030

NO.	DESCRIPTION	NO.	DESCRIPTION
1	M5*25 INNER HEXAGON BOLT	42	CORD CLIP
2	SIDE COVER	43	START HANDLE
3	M8*20 SCREW	44	M5*20 BOTL ASSEMBLY
4	WAVE WASHER	45	STARTER
5	CLUTCH	46	WHEEL
6	8*18*1.2 FLAT WASHER	47	BIG WHEEL
7	M8 FLANGE (8*1)	48	COIL SPRING
8	FLYWHEEL	49	PISTON
9	M5*30 BOLT	50	WASHER $\Phi 5*16*1$
10	15*30*7 OIL SEAL	51	5*16 TAPPING SCREW
11	M5*20 BOLT	52	WASHER
12	IGNITION COIL	53	CIRCLIP
13	STOP SWITCH WIRE	54	DIAL CLAW
14	$\Phi 5*10$ POSITION PIN	55	TORQUE SPRING
15	RIGHT CASE	56	10*14*16 NEEDLE BEARING
16	FUEL TANK	57	DIAL PLATE
17,18,19	M5*20 BOLT ASSEMBLY	58	$\Phi 6$ CIRCLIP
20	ANTI-SHORK BAR	59	SPARK PLUG
21	PRESSURE PLATE	60	$\Phi 5$ WASHERS
22	CRANKSHAFT	61	M5*20 BOLTS
23	6202 BEARING	62	M5*12 BOLT ASSEMBLY
24	GASKET	63	M5*20BOLT ASSEMBLY
25	5*10 POSITION PIN	64	TOP COVER
26	LEFT CASE	65	WOODRUFF KEY
27	12*22*7 OIL SEAL	66	COVER
28	PAPER MAT	67	M5*12 BOLT ASSEMBLY
29	AIR INLET TUBE	68	MUFFLER COVER
30,31,32	M5*25 INNER HEXAGON BOLT	69	$\Phi 6$ WASHERS
33	CARBURETOR PAPER MAT	70	M6*55 INNER HEXAGON BOLT
34	CARBURETOR	71	MUFFLER
35	AIR FILTER INNER COVER	72	M6*12 BOLTS ASSEMBLY
36	AIR FILTER BRACKET	73	MUFFLER WASHER
37	M5*55 BOLT	74	CYLINDER
38	SPONGE	75	CYLINDER PAPER MAT
39	INNER COVER	76	PISTON RING
40	AIR FILTER COVER	77	PISTON PIN
41	M5*16 BOLT ASSEMBLY	100	STARTER ASSEMBLY(42+43..48+50..+52)

SO20120820